

Electrical Standing Sitting Desk

Instruction Manual

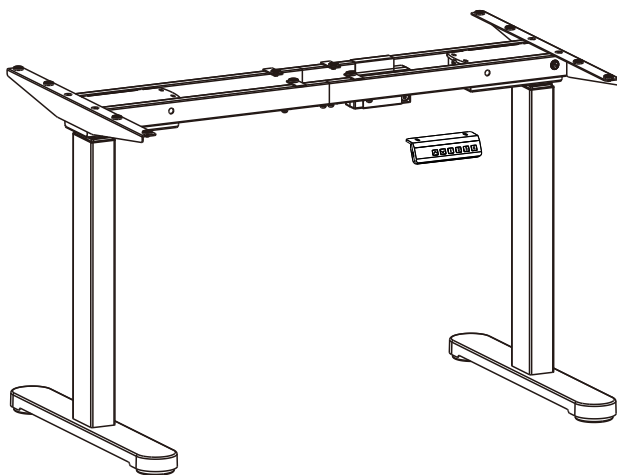

Security Warning

- Please read and follow the instructions in this manual and keep it in a safe place.



To avoid damage to the product or personal injury, please follow the following basic guidelines

- Do not open or disassemble any components, especially the lifting columns and control box, to avoid injury or electric shock;
- When moving, cleaning the lifting table, or adding or removing accessories, make sure that the lifting table is powered off;
- Adjust the lifting within the range of the cable adapter, do not sit or stand on the table to avoid injury;
- Do not let the electrical components come into contact with any liquids to prevent hardware damage and malfunction;
- This product is only for indoor use in a dry environment. Do not use it outdoors or in damp places to prevent accidents such as fires and electric shocks.

Disclaimers:

Under no circumstances shall the manufacturer be liable for damages or losses caused by personal misuse of the product, and the manufacturer does not assume any warranty or compensation responsibility.

■ Checklist and Installation

Before installation, please check according to the provided list of accessories and make sure you have received all parts. If any parts are missing or damaged, please contact us.

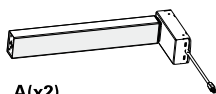

A(x2)
Lifting Column



B(x2)
Left Crossbar



C(x2)
Right Crossbar



D(x2)
Side Bracket



E(x2)
Crossbar Rail

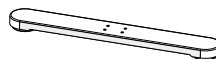

F(x2)
Foot

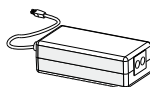

G(x1)
AC Adapter



H(x1)
Adapter Holder

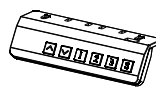

I (x1)
Controller



S-A x4 (+1)
M6x10



S-B x16 (+2)
M6x10

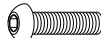

S-C x20(+2)
M6x14



S-D x5(+1)
ST4.2x16



S-E (x1)
4mm Allen Wrench

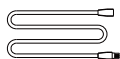

S-F (x1)
Power Cable



S-G x12(+2)
EVA Pad



S-H (x1)
Power Plug



S-I (x3)
Cable Clip

■ Preparation before installation

Height Adjustment Range
28.3"-47.2"(72-120cm)



Power Input
100V-240V



Max. Speed
28mm/s



Operating Noise
<50dB



Max. Load
220lbs/100kg

Tools might use



Pistol drill



Phillips screwdriver

1. Attaching the Crossbars

- Use **Allen Wrench S-E** to tighten **2 M6X10 Screws S-B**.

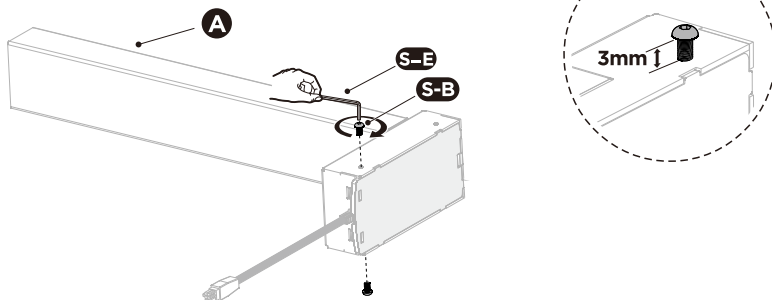

- Attach the **Left Crossbar B** and the **Right Crossbar C** to the **Lifting Column** as shown below.

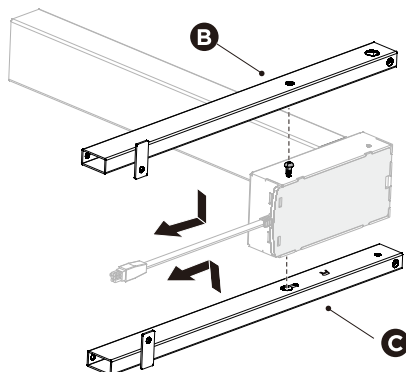

- Secure the crossbar using **2 M6X10 Screws S-B** and tighten all the screws on the crossbar.
- Repeat the same process to attach the other two crossbars on the other side.

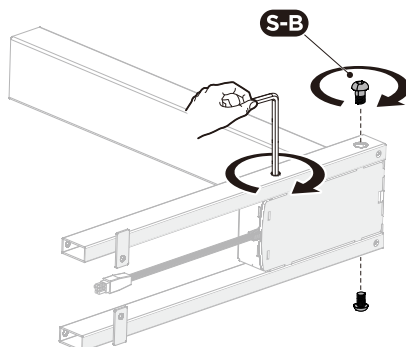

2. Attaching the Side Brackets

- Attach each **Side Bracket D** to the Lifting Column using 2 **M6x10 Screws S-A**.
- Attach **6 EVA Pads S-G** to the **crossbars** and **Side Bracket D** as shown below.
- Repeat the same process to attach the other side bracket.

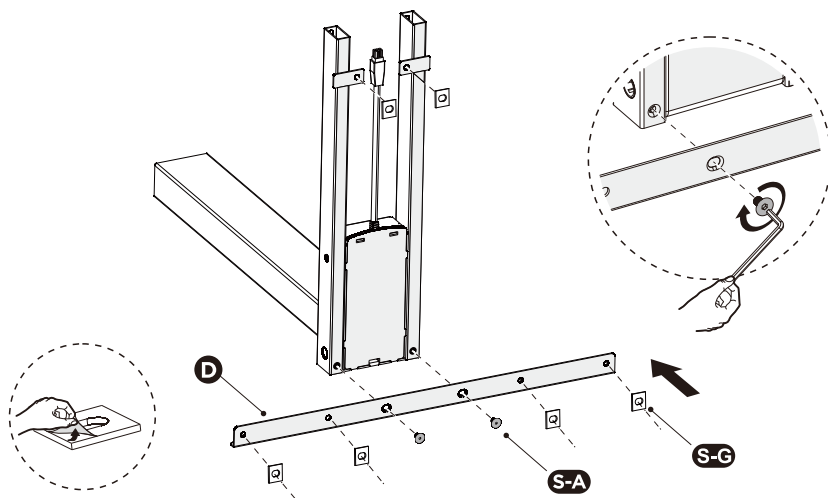

3. Attaching the AC Adapter

- Insert the **AC Adapter G** to the **Adapter Holder H**, then hang the holder on the crossbar.

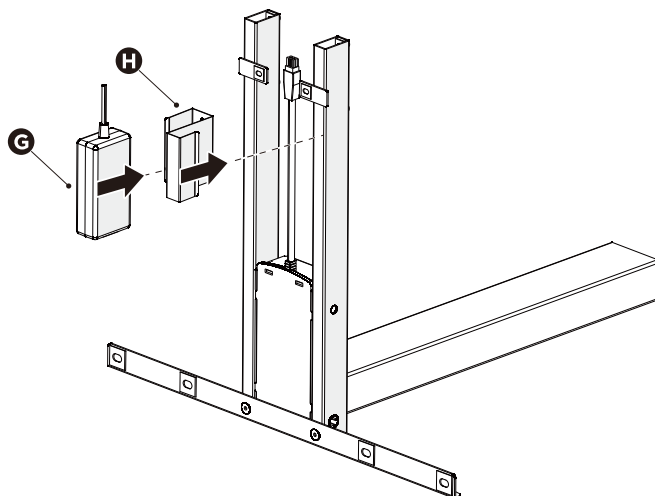

4. Attaching the Feet

- Attaching the **Foot F** to the Lifting Column using **4 M6x14 Screws S-C**.
- Repeat the same process to attach the other foot.

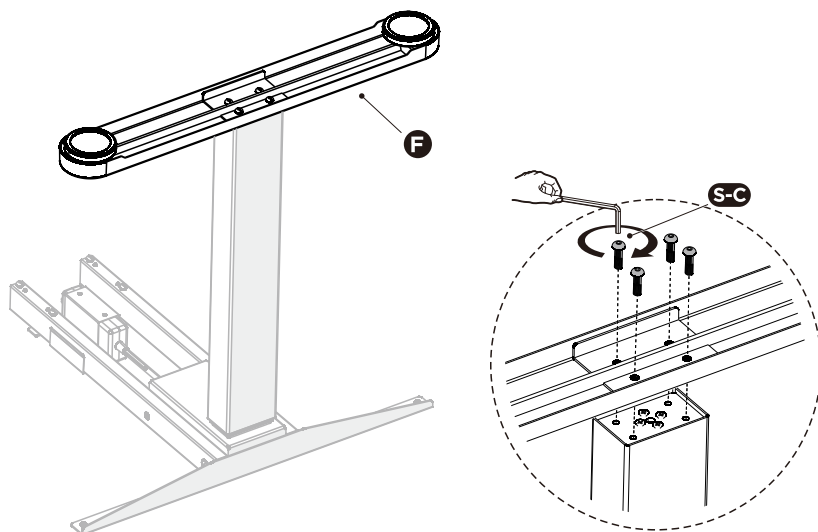

5. Adjusting the Frame and Attaching the Crossbar Rail

- Carefully place the desktop (not included) upside down on the blanket/floor.
- Place the legs one on each side of the top as shown below.
- Adjust the crossbar to the size of the desktop. Ensure that the frame is placed in the center of the desktop.
- Attach the **Crossbar Rails E** as shown below.
- Secure the frame using **4 M6X10 Screws S-B**.
- Tighten the screws on the crossbar.

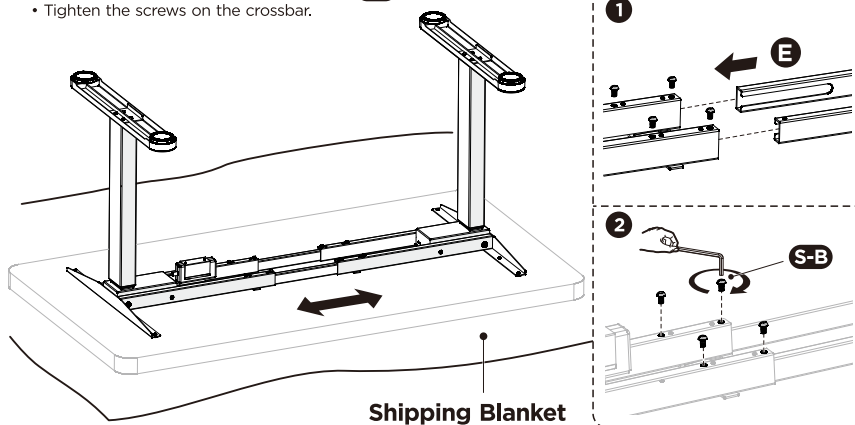

6. Drilling to the Desktop

- Attaching the assembled desk frame to the desktop through the mounting holes found on the Side Brackets and Crossbars as shown in the illustration using **12 M6x14 Screws (S-C)**.

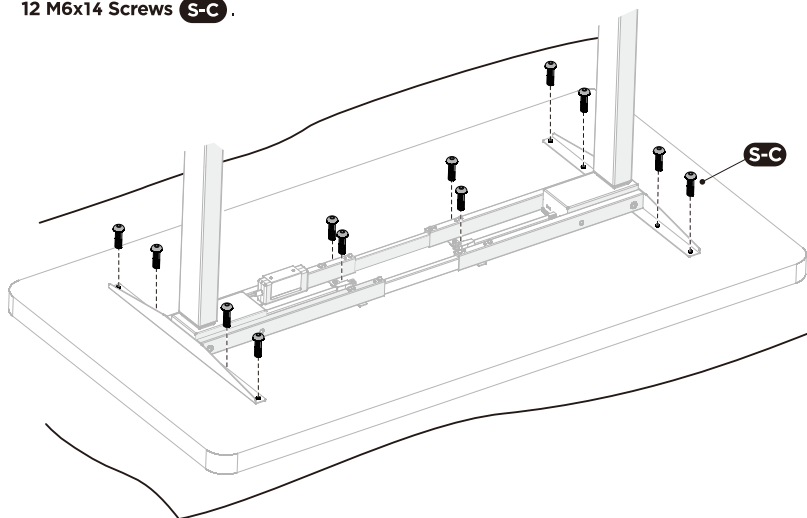

7. Connecting Cords

- Connect the **Controller (I)** with the **AC Adapter** as shown.
- Connect the Controller with **2 Lifting Columns**.
Use the **Power Cable (S-F)** for the **Lifting Column** on the far side.
- Insert the **Power Plug (S-H)** into the **AC Adapter**.

Note:

- *Do not plug into the power before the desk is fully assembled.*

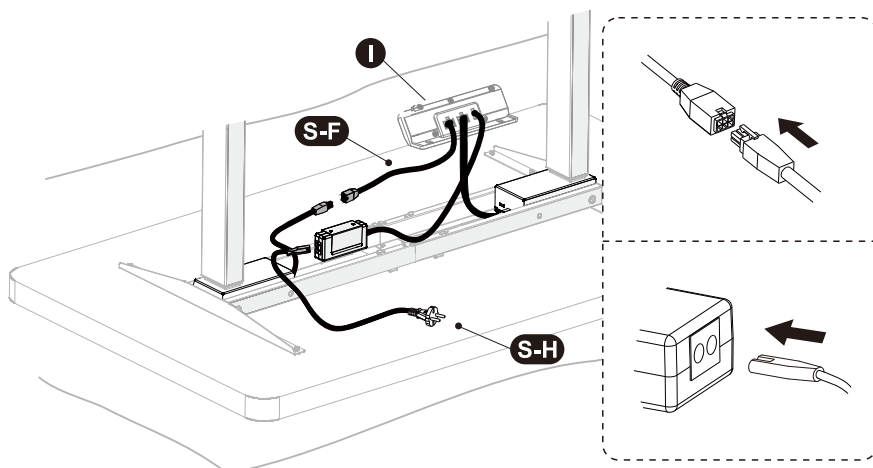

8. Attaching the Controller

- Attach the **Controller** to the desktop using 2 **ST4.2x16 Screws (S-D)**.

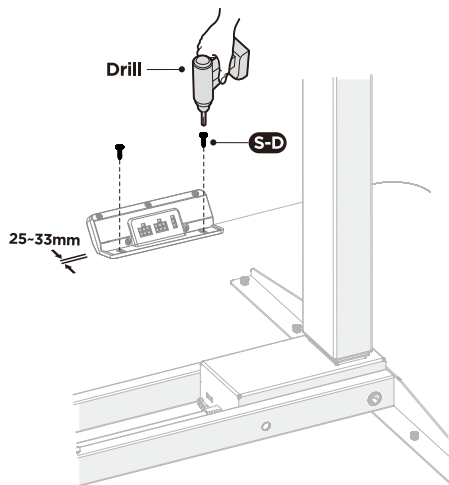

9. Cable Management

- Run the cables through the **Cable Clips (S-I)** and attach the **Cable Clips** to the desktop with **ST4.2x16 Screws (S-D)** to ensure clean and neat surface.

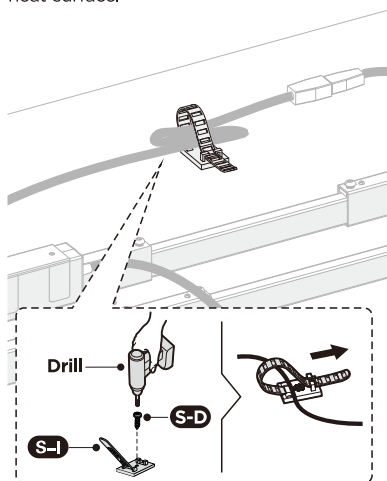

10. Adjusting the Desk

- Turn over the desk with the help of another person.
- There are two adjustable foot pads under each foot. If the floor isn't even, simply turn the pad to adjust the level to make the desk stable.

Tip: Use a bubble level (not included) to check if the desktop is even.

- Using the desk for the first time, you will need to **reset the system**. Please refer to **Digital Control Panel User Guide**.

CAUTION: At least two people are required when turning over the desk, or serious bodily injuries might occur.

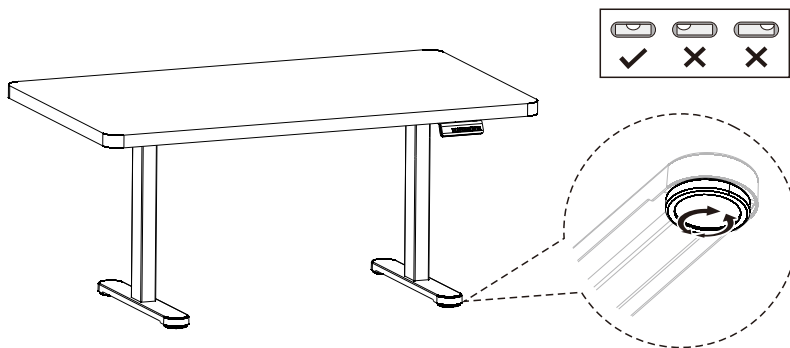

Function Instruction

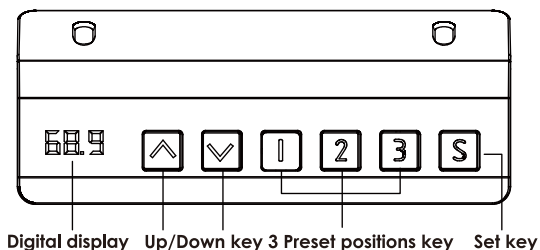

1. Note for first use:

When first powering on the product, the digital display shows the current height (distance from desktop to ground). If it does not match the actual, a reset is required.

2. Reset procedure:

Press and hold the "**Down**" key on the handset until the legs stop moving after 5 seconds. The handset will display "**RST**", indicating reset has started. Keep holding the "**Down**" key until the legs reach their lowest position. Release the "**Down**" key once the legs stop bouncing at the base height. The reset is complete.

3. To move upwards:

Press and hold the "**Up**" key on the handset. The desk will start rising. Release the key to stop.

4. To move downwards:

Press and hold the "**Down**" key on the handset. The desk will start lowering. Release the key to stop.

5. To set a memory position:

With the desk stopped, press the "**S**" key followed by "**1**", "**2**" or "**3**". The current desk height will be saved to the number key pressed. The handset can store 3 height positions which are retained if powered off. To recall a position, simply press the assigned number key and the desk will move to the saved height. Pressing any key during movement will stop the desk.

6. To lock:

Press and hold "**UP**" and "**DOWN**" keys together for 5 seconds. The handset will display "**LOC**" indicating the system is locked from operation.

Press and hold "**UP**" and "**DOWN**" keys together for 5 seconds until the handset displays numbers again.

7. Resistance sensitivity adjustment

Long press "**S**" key to enter the menu options, up and down keys can switch menu options, **PC** for the rise of the sensitivity, **DC** for the fall of the sensitivity, **SS** for the tilt sensor sensitivity adjustment, the setback sensitivity adjustment is divided into 5 gears, of which 0 means that the setback function is closed (shown as: PCO & DCO & SSO), 1-5 value The larger the value 1-5, the higher the sensitivity.

When the table rises or falls, it will bounce back immediately when it meets obstacles and play a protective role.

8. Menu Options

To access the menu, press and hold the "**S**" key for 5 seconds. The menu content will flash. There are several menu items: desktop height setting, collision sensitivity increase for up, collision sensitivity decrease for down, and display units.

Press "**S**" briefly to cycle through the menu pages. Use "**Up**" and "**Down**" to modify the values. To quickly adjust the minimum and maximum height settings, press and hold "**Up**" or "**Down**".

When ready to save, press and hold "S" again until the progress bar on the right fills up completely. "**SUS**" will display if saved successfully, or "**FAL**" for failure. The menu will exit automatically either after saving or after 10 seconds of no activity.

Menu Options	Display	Note
Minimum height setting	Base Height	Setting range: base height to maximum height in 1cm steps Simultaneous setting value should be at least 10cm smaller than the highest height setting value
Maximum height setting	Maximum height	Setting range: base height to maximum height in 1cm steps Simultaneous setting value should be at least 10cm larger than the lowest height setting value
Desktop Thickness	0~30	- Minimum height setting range: 0cm-30cm - Minimum height step: 0.1cm
Collision sensitivity increase for up	PC0~PC5	- Setting range: 0-5 - 0: Disabled - 1~5: Higher number, higher sensitivity
Collision sensitivity increase for down	DC0~DC5	- Setting range: 0-5 - 0: Disabled - 1~5: Higher number, higher sensitivity
Tilt sensor sensitivity setting	SS0 ~ SS5	- Setting range: 0-5 - 0: Disabled - 1~5: Higher number, higher sensitivity
Display units	U-0	Metric units (CM)
Display units	U-1	Imperial units (INCH)

9. Energy Saving Mode

If there is no key press for 1 minute, the controller will be energy saving mode. The digital display will turn off and it will be low power mode. Press any key to exit energy saving mode.

10. Fault Code Table

Fault Code	Description	Solution
Sc0	Self-test failure - Abnormal standby current	Reconnect the power supply, if the alarm persists, replace the drive board.
Sc1	Self-test failure - Main power abnormality	Reconnect the power supply, if the alarm persists, replace the power supply board.
Sc2	Self-test failure - Sensor abnormality	Reconnect the power supply, if the alarm persists, replace the drive board.
HOT	Overheating protection	The system will automatically enter protective mode if overheating occurs. The alarm will clear after 18 minutes.
R-2	Table tilt alarm	The system runs 5cm in the reverse direction and stops. The actual desktop height is displayed when the alarm is cleared.
R-5	Communication failure	Handset and driver communication failure alarm. Check if the connection between the handset and driver is normal.
R-6	Voltage abnormality	It will self-recover. If the failure occurs frequently, replace the main power supply.
RST	Reset incomplete	Continue resetting
Ex0	Drive circuit short	Reconnect the power supply, if the alarm persists, replace the drive board.
Ex1	Overload	Reduce the load. The alarm will automatically clear after 20 seconds.
Ex2	Motor missing phase	Check if the motor phase wires are connected properly.
Ex3	Abnormal running direction	Check if the motor and hall sensor wire order is incorrect.

Fault Code	Description	Solution
Ex4	Collision protection alarm triggered	Run in the opposite direction for 5cm then stop. The alarm code will automatically clear.
Ex5	Motor stall alarm	Check if the lifting leg transmission mechanism is jammed.
Ex6	Motor wire disconnected	Check if the motor wires are connected to the driver.
Ex7	Mechanical failure	Check if the lifting leg structure or motor turbine is damaged.

■ Instructions of Safety and Warnings:

- Any failure to comply with the safety and installation instructions in this manual may cause serious bodily injury.
- Overlooking any part of the instructions, warnings and additional information marked with the **"Note"** and "" may result in serious damage to the system or its components.
- Children should never be allowed to operate or touch the product without direct supervision of an adult. Users should prevent children from being near or around the desk during operation.
- Disabilities and/or lack of experience and knowledge should be prevented from using the product unless under supervision or assisted during use and operation.
- Never sit on or exceed the rated weight of the desk.



Electrical Safety Instructions:

The product is powered by electricity. In order to avoid burns, fire and electric shock, please read the instructions carefully.



Don't clean the product with water while the power is still connected.



Never operate the system if it's in moist environment or its electrical components have contact with liquids.



Don't disassemble or replace components while the power is still connected.



Don't operate the system if the control box makes noise or odor. Alterations of the given power unit and control box aren't allowed.



Never operate the system with a damaged cord or plug. Please contact your point of purchase to replace the damaged parts.



Other Safety Instructions:

- Remove any obstacles from the area around the desk during assembly and subsequent use.
- Organize all cords and wires to prevent any possible tripping or accidents from occurring.
- Never attempt to modify or change the desk frame or components that operate the desk.
- Don't add anything to the adjustable junctions of the desk frame.
- The desk is rated for Indoor Use Only.



Disposal: The product with this mark indicates that this product shouldn't be disposed with other household wastes throughout the EU. To prevent possible harm to the environment or human health from uncontrolled waste disposal, recycle it responsibly to promote the sustainable reuse of material resources. To return your used device, please use the local recycle service or contact your point of purchase to withdrawn the product.